

Terminal Boxes

Series 8252/1



www.stahl.de



14786E00

- > Ex d enclosure made of saltwater-resistant, copper-free aluminium cast alloy
- > Powder coated to RAL 7032
- > Available in 3 different sizes
- > With DIN rail for standard terminals
- > Enclosure with 3, 4 or 5 hubs with metric or NPT threads
- > Drilled holes in the enclosure enable quick and easy mounting
- > In terminal box versions standard cable glands without compound can be used.

E3



The new flameproof terminal boxes Series 8252, made of seawater-resistant copper-free aluminium alloy grant an optimal use in all applications where the type of protection Ex d is needed. By default, three sizes already equipped with threads and pre-installed DIN rails are available. Since the certificate also includes controls, versions with electronic components and relays can be easily realized as well with this series.

	ATEX / IECEx / GOST					
Zone	0	1	2	20	21	22
For use in		x	x		x	x

Explosion Protection	
Global (IECEx) Gas and dust	IECEx BVS 11.0059X Ex db [ia Ga] [ib] IIC T4...T6 Gb Ex tb IIC T80°C...T130°C Db IP66
Europe (ATEX) Gas and dust	BVS 11 ATEX E 114 X ⊕ II 2(1) G Ex db [ia Ga] [ib] IIC T4...T6 Gb ⊕ II 2 D Ex tb IIC T80°C...T130°C Db IP66
India (PESO) Gas and dust	A/P/HQ/MH/104/2563 (P284425) Ex db [ia Ga] [ib] IIC T4...T6 Gb Ex tb IIC T80°C...T130°C Db IP66

WebCode 8252A

Terminal Boxes

Series 8252/1

Position of Hubs

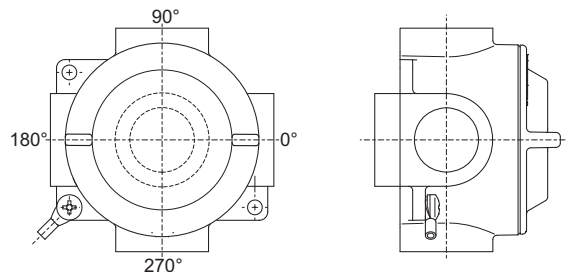

15031E00

Selection Table

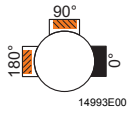
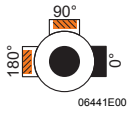
Configu- ration	Version	Enclosure size	Hub metric or NPT thread				Order number	Weight	
			Enclosure base	0°	90°	180°			270°
	GUA 16 M20	2: ∅ 90	--	M20	✓	✓	--	8252/12-0B110-111	0.620
	GUA 26 M25	2: ∅ 90	--	M25	✓	✓	--	8252/12-0C110-111	0.610
	GUA 36 M32	2: ∅ 90	--	M32	✓	✓	--	8252/12-0D110-111	0.600
	GUA 47 M32	3: ∅ 110	--	M32	✓	✓	--	8252/13-0D110-111	1.090
	GUA 59 M40	4: ∅ 145	--	M40	✓	✓	--	8252/14-0E110-111	1.870
	GUA 16	2: ∅ 90	--	1/2"	✓	✓	--	8252/12-0H110-111	0.620
	GUA 26	2: ∅ 90	--	3/4"	✓	✓	--	8252/12-0I110-111	0.600
	GUA 36	2: ∅ 90	--	1"	✓	✓	--	8252/12-0J110-111	0.600
	GUA 47	3: ∅ 110	--	1 1/4"	✓	✓	--	8252/13-0K110-111	1.060
	GUA 59	4: ∅ 145	--	1 1/2"	✓	✓	--	8252/14-0L110-111	1.840
	GUAB 16 M20	2: ∅ 90	M20	M20	✓	✓	--	8252/12-BB110-111	0.670
	GUAB 26 M25	2: ∅ 90	M25	M25	✓	✓	--	8252/12-CC110-111	0.660
	GUAB 36 M32	2: ∅ 90	M32	M32	✓	✓	--	8252/12-DD110-111	0.630
	GUAB 47 M32	3: ∅ 110	M32	M32	✓	✓	--	8252/13-DD110-111	1.080
	GUAB 59 M40	4: ∅ 145	M40	M40	✓	✓	--	8252/14-EE110-111	1.880
	GUAB 69 M50	4: ∅ 145	M50	M50	✓	✓	--	8252/14-FF110-111	1.810
	GUAB 16	2: ∅ 90	1/2"	1/2"	✓	✓	--	8252/12-HH110-111	0.680
	GUAB 26	2: ∅ 90	3/4"	3/4"	✓	✓	--	8252/12-II110-111	0.650
	GUAB 36	2: ∅ 90	1"	1"	✓	✓	--	8252/12-JJ110-111	0.630
	GUAB 47	3: ∅ 110	1 1/4"	1 1/4"	✓	✓	--	8252/13-KK110-111	1.040
GUAB 59	4: ∅ 145	1 1/2"	1 1/2"	✓	✓	--	8252/14-LL110-111	1.840	
GUAB 69	4: ∅ 145	2"	2"	✓	✓	--	8252/14-MM110-111	1.740	

 = ✓ thread with stopping plug

Note Cable glands must be ordered separately.

Terminal Boxes

Series 8252/1

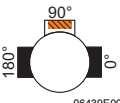
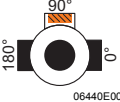
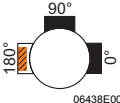
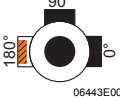

Selection Table

Configu- ration	Version	Enclosure size	Hub metric or NPT thread				Order number	Weight	
			Enclosure base	0°	90°	180°			270°
 06439E00	GUAC 16 M20	2: ∅ 90	--	M20	✓	M20	--	8252/12-0B1B0-111	0.600
	GUAC 26 M25	2: ∅ 90	--	M25	✓	M25	--	8252/12-0C1C0-111	0.590
	GUAC 36 M32	2: ∅ 90	--	M32	✓	M32	--	8252/12-0D1D0-111	0.560
	GUAC 47 M32	3: ∅ 110	--	M32	✓	M32	--	8252/13-0D1D0-111	1.050
	GUAC 59 M40	4: ∅ 145	--	M40	✓	M40	--	8252/14-0E1E0-111	1.810
	GUAC 69 M50	4: ∅ 145	--	M50	✓	M50	--	8252/14-0F1F0-111	1.740
	GUAC 16	2: ∅ 90	--	1/2"	✓	1/2"	--	8252/12-0H1H0-111	0.610
	GUAC 26	2: ∅ 90	--	3/4"	✓	3/4"	--	8252/12-0I1I0-111	0.580
	GUAC 36	2: ∅ 90	--	1"	✓	1"	--	8252/12-0J1J0-111	0.560
	GUAC 47	3: ∅ 110	--	1 1/4"	✓	1 1/4"	--	8252/13-0K1K0-111	1.010
	GUAC 59	4: ∅ 145	--	1 1/2"	✓	1 1/2"	--	8252/14-0L1L0-111	1.770
	GUAC 69	4: ∅ 145	--	2"	✓	2"	--	8252/14-0M1M0-111	1.670
 06440E00	GUAD 16 M20	2: ∅ 90	M20	M20	✓	M20	--	8252/12-BB1B0-111	0.660
	GUAD 26 M25	2: ∅ 90	M25	M25	✓	M25	--	8252/12-CC1C0-111	0.640
	GUAD 36 M32	2: ∅ 90	M32	M32	✓	M32	--	8252/12-DD1D0-111	0.600
	GUAD 16	2: ∅ 90	1/2"	1/2"	✓	1/2"	--	8252/12-HH1H0-111	0.660
	GUAD 26	2: ∅ 90	3/4"	3/4"	✓	3/4"	--	8252/12-II1I0-111	0.620
	GUAD 36	2: ∅ 90	1"	1"	✓	1"	--	8252/12-JJ1J0-111	0.600
 06438E00	GUAL 16 M20	2: ∅ 90	--	M20	M20	✓	--	8252/12-0BB10-111	0.600
	GUAL 26 M25	2: ∅ 90	--	M25	M25	✓	--	8252/12-0CC10-111	0.590
	GUAL 36 M32	2: ∅ 90	--	M32	M32	✓	--	8252/12-0DD10-111	0.560
	GUAL 47 M32	3: ∅ 110	--	M32	M32	✓	--	8252/13-0DD10-111	1.050
	GUAL 59 M40	4: ∅ 145	--	M40	M40	✓	--	8252/14-0EE10-111	1.810
	GUAL 69 M50	4: ∅ 145	--	M50	M50	✓	--	8252/14-0FF10-111	1.740
	GUAL 16	2: ∅ 90	--	1/2"	1/2"	✓	--	8252/12-0HH10-111	0.610
	GUAL 26	2: ∅ 90	--	3/4"	3/4"	✓	--	8252/12-0II10-111	0.580
	GUAL 36	2: ∅ 90	--	1"	1"	✓	--	8252/12-0JJ10-111	0.560
	GUAL 47	3: ∅ 110	--	1 1/4"	1 1/4"	✓	--	8252/13-0KK10-111	1.010
	GUAL 59	4: ∅ 145	--	1 1/2"	1 1/2"	✓	--	8252/14-0LL10-111	1.770
	GUAL 69	4: ∅ 145	--	2"	2"	✓	--	8252/14-0MM10-111	1.670
 06443E00	GUAM 16 M20	2: ∅ 90	M20	M20	M20	✓	--	8252/12-BBB10-111	0.660
	GUAM 26 M25	2: ∅ 90	M25	M25	M25	✓	--	8252/12-CCC10-111	0.640
	GUAM 36 M32	2: ∅ 90	M32	M32	M32	✓	--	8252/12-DDD10-111	0.600
	GUAM 47 M32	3: ∅ 110	M32	M32	M32	✓	--	8252/13-DDD10-111	1.050
	GUAM 69 M50	4: ∅ 145	M50	M50	M50	✓	--	8252/14-FFF10-111	1.730
	GUAM 16	2: ∅ 90	1/2"	1/2"	1/2"	✓	--	8252/12-HHH10-111	0.660
	GUAM 26	2: ∅ 90	3/4"	3/4"	3/4"	✓	--	8252/12-III10-111	0.620
	GUAM 36	2: ∅ 90	1"	1"	1"	✓	--	8252/12-JJJ10-111	0.600
	GUAM 47	3: ∅ 110	1 1/4"	1 1/4"	1 1/4"	✓	--	8252/13-KKK10-111	0.980
	GUAM 69	4: ∅ 145	2"	2"	2"	✓	--	8252/14-MMM10-111	1.610

 = ✓ thread with stopping plug

Note Cable glands must be ordered separately.

E3

Terminal Boxes

Series 8252/1

Selection Table

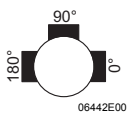
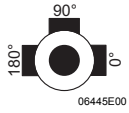
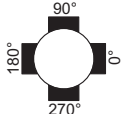
Configu- ration	Version	Enclosure size	Hub metric or NPT thread				Order number	Weight	
			Enclosure base	0°	90°	180°			270°
 06442E00	GUAT 16 M20	2: ∅ 90	--	M20	M20	M20	--	8252/12-0BBB0-111	0.590
	GUAT 26 M25	2: ∅ 90	--	M25	M25	M25	--	8252/12-0CCC0-111	0.570
	GUAT 36 M32	2: ∅ 90	--	M32	M32	M32	--	8252/12-0DDD0-111	0.530
	GUAT 47 M32	3: ∅ 110	--	M32	M32	M32	--	8252/13-0DDD0-111	1.020
	GUAT 59 M40	4: ∅ 145	--	M40	M40	M40	--	8252/14-0EEE0-111	1.760
	GUAT 69 M50	4: ∅ 145	--	M50	M50	M50	--	8252/14-0FFF0-111	1.660
	GUAT 16	2: ∅ 90	--	1/2"	1/2"	1/2"	--	8252/12-0HHH0-111	0.590
	GUAT 26	2: ∅ 90	--	3/4"	3/4"	3/4"	--	8252/12-0III0-111	0.550
	GUAT 36	2: ∅ 90	--	1"	1"	1"	--	8252/12-0JJJ0-111	0.530
	GUAT 47	3: ∅ 110	--	1 1/4"	1 1/4"	1 1/4"	--	8252/13-0KKK0-111	0.950
	GUAT 59	4: ∅ 145	--	1 1/2"	1 1/2"	1 1/2"	--	8252/14-0LLL0-111	1.690
GUAT 69	4: ∅ 145	--	2"	2"	2"	--	8252/14-0MMM0-111	1.540	
 06445E00	GUAW 16 M20	2: ∅ 90	M20	M20	M20	M20	--	8252/12-BBBB0-111	0.650
	GUAW 26 M25	2: ∅ 90	M25	M25	M25	M25	--	8252/12-CCCC0-111	0.620
	GUAW 16	2: ∅ 90	1/2"	1/2"	1/2"	1/2"	--	8252/12-HHHH0-111	0.650
	GUAW 26	2: ∅ 90	3/4"	3/4"	3/4"	3/4"	--	8252/12-IIII0-111	0.600
 06444E00	GUAX 16 M20	2: ∅ 90	--	M20	M20	M20	M20	8252/12-0BBBB-111	0.640
	GUAX 26 M25	2: ∅ 90	--	M25	M25	M25	M25	8252/12-0CCCC-111	0.610
	GUAX 36 M32	2: ∅ 90	--	M32	M32	M32	M32	8252/12-0DDDD-111	0.550
	GUAX 47 M32	3: ∅ 110	--	M32	M32	M32	M32	8252/13-0DDDD-111	0.990
	GUAX 59 M40	4: ∅ 145	--	M40	M40	M40	M40	8252/14-0EEEE-111	1.730
	GUAX 69 M50	4: ∅ 145	--	M50	M50	M50	M50	8252/14-0FFFF-111	1.600
	GUAX 16	2: ∅ 90	--	1/2"	1/2"	1/2"	1/2"	8252/12-0HHHH-111	0.640
	GUAX 26	2: ∅ 90	--	3/4"	3/4"	3/4"	3/4"	8252/12-0IIII-111	0.590
	GUAX 36	2: ∅ 90	--	1"	1"	1"	1"	8252/12-0JJJJ-111	0.550
	GUAX 47	3: ∅ 110	--	1 1/4"	1 1/4"	1 1/4"	1 1/4"	8252/13-0KKKK-111	0.900
GUAX 59	4: ∅ 145	--	1 1/2"	1 1/2"	1 1/2"	1 1/2"	8252/14-0LLLL-111	1.650	
GUAX 69	4: ∅ 145	--	2"	2"	2"	2"	8252/14-0MMMM-111	1.450	

 = ✓ thread with stopping plug

Note Cable glands must be ordered separately.

Technical data

Electrical data

Rated operational voltage	max. 690 V depending on explosion-protected built-in components used
Rated operational current	max. 175 A depending on explosion-protected built-in components used

Ambient conditions

Ambient temperature	-60 ... +70 °C depending on explosion-protected built-in components used
---------------------	---

Mechanical data

Enclosure material	aluminium cast alloy copper-free, powder-coated to RAL 7032
Seal	silicone O-ring
Protective conductor connection	M6 earth bolt, inside/outside on the enclosure
Tightening torque	screw of the protective conductor connection: 2.8 Nm
Degree of protection	IP66 acc. to IEC/EN 60529
Assembly	2 mounting holes

Terminal Boxes

Series 8252/1



Max. Number of Terminal Blocks which can be fitted

	MBK 2,5/E	MBK 3/E-Z	MBK 5/E-Z	UT 2,5	UT 4	UT 6	UT 10	UT 16	ST 2,5	ST 4	ST 6	STTB 2,5	STTB 4
Enclosure size 2 8252/12	8	8	8	-	-	-	-	-	-	-	-	-	-
Enclosure size 3 8252/13	10	10	8	6	5	4	-	-	6	4	-	-	-
Enclosure size 4 8252/14	17	17	14	11	11	10	6	5	11	10	4	5	3

E3

Accessories and Spare Parts

Designation	Description	Dimensions in mm	Art. no.	Weight kg
DIN rail	TS15 for size 2	15 x 5.5 x 72	211473	0.010
	TS15 for size 3	15 x 5.5 x 86	211474	0.010
	TS15 for size 4	15 x 5.5 x 120	211475	0.020
	TS35 for size 3	35 x 7.5 x 80	211858	0.030
	TS35 for size 4	35 x 7.5 x 115	211859	0.040
Mounting plate made of steel sheet	for size 2	58 x 58 x 2	211477	0.050
	for size 3	70 x 70 x 2	211478	0.070
	for size 4	100 x 100 x 2	211479	0.150
O-ring seal	for size 2	73.5x3	211481	0.002
	for size 3	88.5x3	211482	0.003
	for size 4	123.5x3	211483	0.004

Note Cable glands must be ordered separately.

Selection Table - Cable glands

Direct entry in Ex d enclosure, selection of cable entries as per IEC 60079-14, EN 60079-14

Preferred types of CMP screw connections for direct entry

without hardening compound:

- CMP A2F for unarmoured cables

- CMP E1FU for armoured cables

with respective hardening compound:

- CMP PXSS2KREX for unarmoured cables

- CMP PX2K-REX for armoured cables

Note Further information at: www.r-stahl.com

Terminal Boxes

Series 8252/1

Dimensional Drawings (All Dimensions in mm) - Subject to Alterations

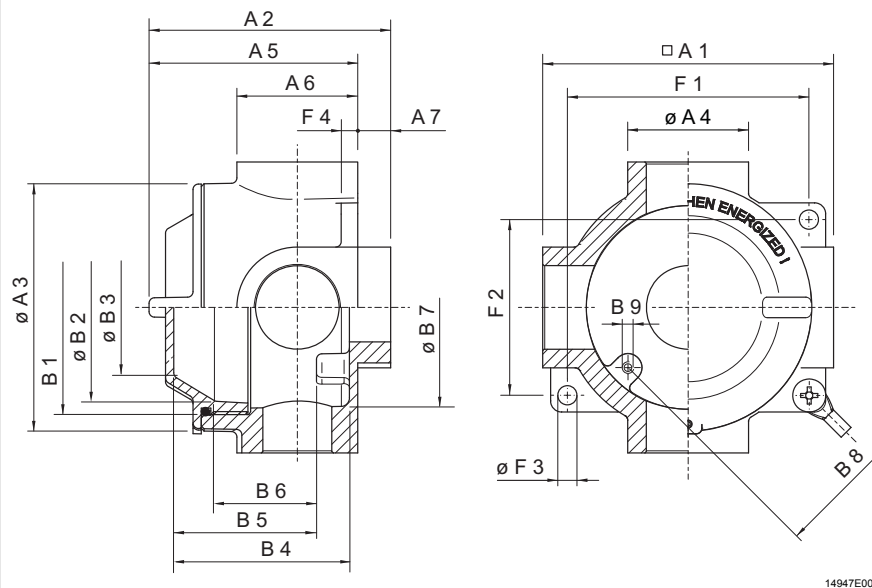

Enclosure (dimensions in mm)

	Size 2 8252/12-....	Size 3 8252/13-....	Size 4 8252/14-....
□A1	106	120	156
A2	88	110	126
∅A3	90	110	145
∅A4	44	54	75
A5	76	99	115
A6	44	54	75
A7	12	12	12
B1	M80	M95	M130
∅B2	72	85	123
∅B3	52	67	99
B4	64	83	98
B5	52	71	86
B6	36	57	66
∅B7	73	87	123
B8	61	77	111
B9	M4	M4	M4
F1	88	102	136
F2	64	78	96
∅F3	7	7	7
F4	6	6	3
Max. thread size			
Metric	M32	M40	M63
NPT	1"	1-1/4"	2"

We reserve the right to make alterations to the technical data, dimensions, weights, designs and products available without notice. The illustrations cannot be considered binding.